



NUCB BUSINESS SCHOOL

NUCB Business School is situated in Nagoya city as a downtown graduate campus. Centrally located in Japan, access to Kyoto and Tokyo is fast and convenient. NUCB offers the all-English Global Leader Program (GLP) at the Masters level for MSc and MBA students. The goal of our program is to cultivate highly skilled professionals who develop a global perspective, a strong sense of ethics, and the ability to contribute positively to the international business community.

www.nucba.ac.jp/en

CONTACTS

Ms. Narumi Futamura
Incoming Exchange Coordinator / Student Support
Email: narumi_futamura@nucba.ac.jp

Ms. Ayumi Kobayashi
Academic Affairs / Outgoing Exchange Coordinator
Email: ayumikobayashi@nucba.ac.jp

Mr. Leonard Leiser
Coordinator for International Development
Email: leiser@nucba.ac.jp

International Affairs Office
Email: mba_glp@nucba.ac.jp

APPLICATION PROCEDURES

Deadline for Document Submission

- Spring Semester 2018 December 1, 2017
- Fall Semester 2018 May 1, 2018

Application Steps

- Students submit application package to NUCB
- NUCB sends the Certificate of Eligibility (COE) and Acceptance Letter to each school after COE is issued by the Immigration Office
- Students apply for Student Visa at the Japanese Embassy in their home country with the COE and Acceptance letter

*For details, please refer to the email sent to partner schools

ACADEMIC CALENDAR

Spring Semester 2018*

- Term 1 April – May
- Term 2 June – mid-July

Fall Semester 2018*

- Term 1 September – October
- Term 2 November – mid-December
- Term 3 January to February (2019)

*exact dates TBD

Office Hours

Tue. – Sun. / 10:00 a.m. – 8:00 p.m.

MSC / MBA PROGRAM

Semester and Terms

An academic year at NUCB is separated into Spring Semester and Fall Semester

- 14 or 21 weeks per semester
- 2 or 3 seven-week terms per semester
- Orientation day conducted at start of semester

Courses

- Regular courses are taught on weekdays over the course of seven weeks
- Intensive courses are taught intensively over one or two weekends for 3-4 days

TUITION AND FEES

Exchange students are responsible to pay their home institution's tuition. Through the exchange program with NUCB, students are not responsible for making a tuition payment to NUCB.

However, students need to purchase textbooks and other materials by themselves because these costs are not covered by the exchange agreement. Most courses are conducted by using e-casebooks. Cases are provided in data form and students must pay in cash at the office. E-case fees differ by course and the costs approximately 2,000 JPY to 4,000 JPY per course.

We also require all students from our partners' schools to pay for the student insurance fee, which is 800 JPY per student upon their arrival.

CREDITS / COURSES

Grading

| Grades | Definition | Grading points | Applied Grading Curve |
|--------|-----------------|----------------|-----------------------|
| A | Excellent | 4 | Top 10% |
| B | Good | 3 | Next 30% |
| C | Passable | 2 | Next 30% |
| D | Lowest standard | 1 | Next 20% |
| F | Failure | 0 | Lowest 10% |
| IN | Incomplete | -1 | - |

Credit Calculation

- 2 NUCB Credits = 3 ECTS Credits
- 2 NUCB Credits = 90 hours of study
- 90 hours = 23.3 class hours + 66.7 self-study
- Class hours = 100 min x 14 lecture (exam included)
- NUCB uses curved grading system (see above)

Exchange Students

Up to 18 credits (9 courses) can be registered per semester. If the home institution requires students to take more credits during their exchange period, please consult with NUCB administration.

Double Degree Students

- 18 credits (9 courses) full per-semester load
- 40 credits full year course load
 - o 34 credits (17 courses)
 - o 4 credits (1 year-long course) Case Writing
 - o 2 credits (1 course) Business Plan
 - o Japanese lang. credits not counted
 - o Up to 10 credits can be transferred in

TRANSCRIPTS

Transcripts are sent to the home institution within two months after the completion of the semester.

VISA REQUIREMENTS

Cost of Visa Application
Passport / ID
Health Insurance requirements

**None
Needed
Compulsory***



ARRIVAL IN NAGOYA

Transportation

NUCB provides transportation service on arrival from the downtown campus (not from Chubu International Airport) to the student residence on specified arrival days set by NUCB administration.

In some cases, students are asked to make arrangement for accommodation themselves in these situations,

- arrive at downtown campus after 6:00 p.m. (including the specified arrival dates)
- arrive in Japan prior to the specified arrival days

For those who arrive at our campus after the specified days, transportation services will not be available. In this case, we ask students to visit NUCB during office hours for guidance on how to get to the residence.



ACCOMMODATION

NUCB Global Center

3-15-2 Higashiyama Motomachi
Chikusa-ku, Nagoya-shi, Aichi-ken

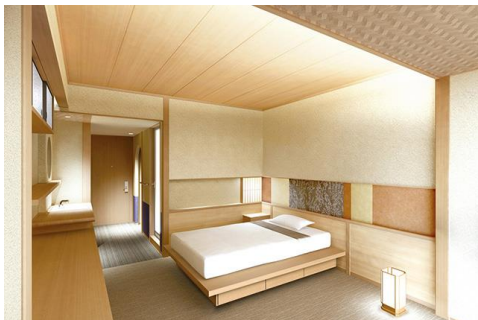

44 fully-furnished rooms for graduate school international students only, includes common dining space, gym, theater room, and seminar room

- ¥88,250 / month for rent (includes breakfast Tue. – Sat. during academic terms, utilities, common service fee)
- ¥10,000 non-refundable administrative fee
- ¥50,000 refundable deposit
- NUCB Scholarship applies for qualified students
 - o ¥25,000 or ¥35,000 per month

Chiyoda Residence

2-24-37 Chiyoda
Naka-ku, Nagoya-shi, Aichi-ken



94 fully-furnished rooms for undergraduate and graduate students, located in central Nagoya near Tsuruma Park, Osu Kannon and Sakae district

- ¥73,250 / month for rent (includes utilities and common service fee)
- ¥22,500 non-refundable entrance fee for semester exchange
- ¥25,000 non-refundable entrance fee for one-year exchange
- ¥30,000 refundable deposit